

Copper Nickel Butt Welding Fittings

Caps - NAVSEA 810-1385880, Revision D

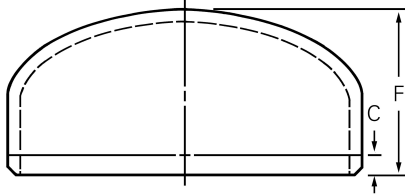

- UNS Designation Numbers: 90-10 (UNS C70600) and 70-30 (UNS C71500).
- Nominal Chemicals 90-10: Copper 88.6%, Nickel 10.0%, Iron 1.4%.
- Nominal Chemicals 70-30: Copper 69.5%, Nickel 30.0%, Iron 0.5%.

Nominal Pipe Size	OD	C* (Min)	F	Class 200				Class 50		
				Nominal Wall	Weight	90-10 Part Number	70-30 Part Number	Nominal Wall	Weight	90-10 Part Number
1	1.315	1/2	1 1/2	.065	.2	129325	129341			
1 1/4	1.660	9/16	1 1/2	.072	.2	129414	477566			
1 1/2	1.900	11/16	1 1/2	.072	.2	129375	129391			
2	2.375	23/32	1 1/2	.083	.5	129430	129456			
2 1/2	2.875	7/8	1 1/2	.083	.8	129472	129498			
3	3.500	29/32	2	.095	1	129511	111534			
3 1/2	4.000	15/16	2 1/2	.095	1.5	249395	477574			
4	4.500	31/32	2 1/2	.109	2	129537	111550			
5	5.563	1 3/32	3	.125	3	129553	129579			
6	6.625	1 11/64	3 1/2	.134	4.5	129595	249387			
8	8.625	1 3/8	4	.148	7	129618	249379			
10	10.75	1 9/16	5	.187	14	129634	249361	.134	10	463800
12	12.75	1 11/16	6	.250	27	129650	477582	.156	17	435823
14	14.00			.250	28	453465	477401	.165	19	460616
16	16.00			.250	37	477524	477540	.165	24	477710
18	18.00			.250	47	477451	477508	.180	33	477736
20	20.00			.250	49	477388	477396	.180	35	439267
24	24.00			.250	51	476293	477427	.180	37	431780

Sizes not shown may be available upon request.
Available in "regular" thickness (similar to Schedule 40s).