

Copper-Nickel Belled End Fittings

Straight Tees - NAVSEA 802-5959353 App.B, MSS SP-119

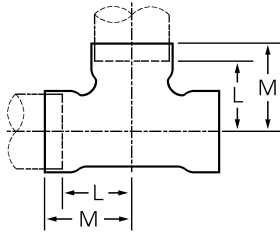

- UNS Designation Numbers: 90-10 (UNS C70600) and 70-30 (UNS C71500).
- Nominal Chemicals 90-10: Copper 88.6%, Nickel 10.0%, Iron 1.4%.
- Nominal Chemicals 70-30: Copper 69.5%, Nickel 30.0%, Iron 0.5%.

Nominal Pipe Size	OD	Minimum Wall	M	L	Weight	NAVSEA/MSS	
						90-10 Part Number	70-30 Part Number
1/4	.540	.065	0.69	0.38	.1	481264	481280
3/8	.675	.065	0.91	0.59	.2	480276	481256
1/2	.840	.065	1.09	0.78	.4	481303	481329
3/4	1.050	.065	1.25	0.94	.5	481337	481345
1	1.315	.065	1.50	1.12	.7	481361	481387
1 1/4	1.660	.072	1.88	1.44	.9	481400	481426
1 1/2	1.900	.072	2.25	1.69	2	480284	481442
2	2.375	.083	2.50	1.94	2	470124	481549
2 1/2	2.875	.083	3.00	2.25	4	470132	481573
3	3.500	.095	3.38	2.62	4	470158	481599
3 1/2*	4.000	.095	3.75	2.94	7	568511	494495
4	4.500	.109	4.12	3.31	8	467472	470653
5	5.563	.125	4.88	3.94	11	470166	481620
6	6.625	.134	5.62	4.62	18	470174	481646
8	8.625	.151	7.00	5.75	36	467317	481662
10	10.75	.187	8.50	7.06	67	467325	467333
12	12.75	.250	10.00	8.43	135	481688	481701

Dimension M is center to end of the fitting.

Dimension L is center of fitting to end of adjoining pipe.

Dimensions are in inches.

Sizes not shown may be available upon request.

*3 1/2" size is not included in NAVSEA or MSS, dimensions per Alaskan standards.